

Hook Mounted Hoists

K5 Series



K5 Series

Capacity:
550-2200 lbs. 250-1000 kg

- Rotary Vane Air Motor
- Rope or Pendent Control
- Link or Roller Chain



Single Reeved
550 lbs. (250 kg) & 1100 lbs.
(500 kg) Capacity

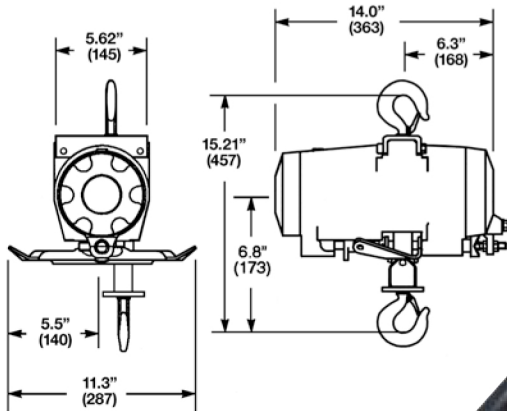

Double Reeved
2200 lbs. (1000 kg) Capacity

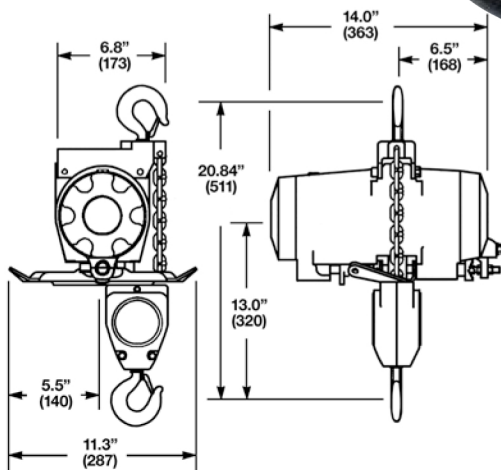

K5 H A 05 L P E L --- A A A 05

SERIES
K5

TYPE MOUNT
H = Hook

FEATURES
A = Standard Unit
H = Hi Temp Grease
P = Epoxy Paint
S = Epoxy Paint/Hi Temp Grease

CAPACITY
05 = 550 lbs.
11 = 1100 lbs.
22 = 2200 lbs.

CHAIN TYPE
L = Link
R = Roller

CONTROL TYPE
P = Pendant (Standard-2LVR)
R = Rope
W = None-Pendant Ready
X = None

CONTROL LENGTH
E = 5 FT T = 20 FT
J = 10 FT Y = 25 FT
O = 15 FT Z = None

CHAIN OPTIONS
L = Link
R = Standard Roller
X = No Chain

CAPACITY RATING
05 = 550 lbs. (05)
06 = 550 lbs. (22)
11 = 1100 lbs. (11)
12 = 1100 lbs. (22)
22 = 2200 lbs. (22)

VINTAGE
A

LOWER HOOK
A = Standard Link (05/11)
B = Bullard Link (05/11)
C = Standard Roller (05/11)
D = Bullard Roller (05/11)
E = Standard Link (22)
F = Bullard Link (22)
G = Standard Roller (22)
H = Bullard Roller (22)
X = No Hook

UPPER HOOK
A = Standard (05/11)
B = Bullard (05/11)
C = Standard (22)
D = Bullard (22)
X = No Hook

AMOUNT OF LIFT
--- Specify Length in Feet, 3 digits
Example: 10' lift 010

Note: Numbers in parentheses following an option, represent the hoist capacities for which that option is available.

Model Number		Chain Type	Capacity		Lifting & Lowering Speeds				Reeves	Weight	
Pendant Control	Rope Control		lbs.	kg	Lifting		Lowering			lbs.	kg
					fpm	mpm	fpm	mpm			
K5HA05LPEL010AAA05	K5HA05LREL010AAA05	Link	550	250	40-67	12-20	110-147	33-44	1	42	19
K5HA05RPER010ACA05	K5HA05RRER010ACA05	Roller	550	250	40-67	12-20	110-147	33-44	1	42	19
K5HA11LPEL010AAA11	K5HA11LREL010AAA11	Link	1100	500	20-50	6-15	80-120	24-36	1	42	19
K5HA11RPER010ACA11	K5HA11RRER010ACA11	Roller	1100	500	20-50	6-15	80-120	24-36	1	42	19
K5HA22LPEL010CEA22	K5HA22LREL010CEA22	Link	2200	1000	10-25	3-7	40-60	12-18	2	54	25
K5HA22RPER010CGA22	K5HA22RRER010CGA22	Roller	2200	1000	10-25	3-7	40-60	12-18	2	54	25

General:
Air Inlet: 1/2" NPT (use 3/4" I.D. Hose)
Performance rated at 90 psig (6.2 bar/620 kPa) air pressure.
Air Consumption 75 cfm (2.12m³/min.) at rated load.

Standard Equipment:
Hook mounted air hoist with 10 ft. (3.0m) lift
Rope Control: 5 ft. (1.5m) rope length
Pendant Control: 5 ft. (1.5m) hose length

Extra Equipment:
Chain container – page 54-55
Hoist trolleys – page 22
Auxiliary cable (Backup suspension) – page 57
Air strainer intake fitting – A10161
Piped exhaust adapter (3/4"NPT) – 536567